

PV16-PV23

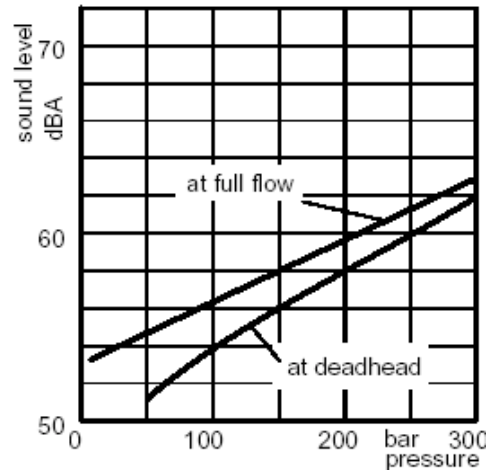

Noise Levels

PV16-PV23



Efficiency, power consumption

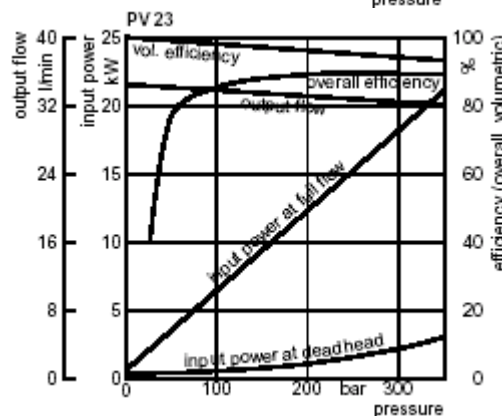
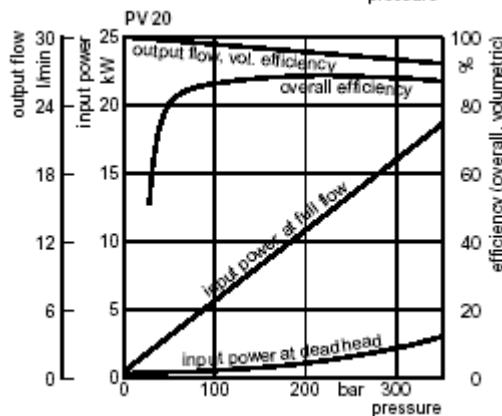
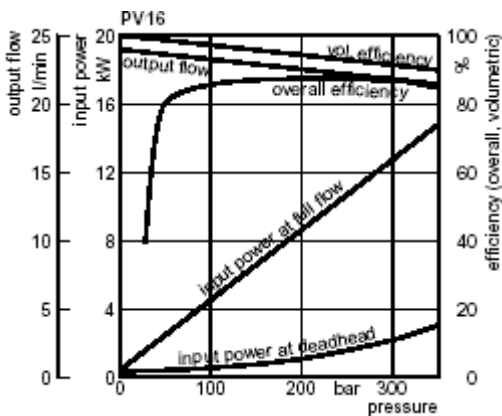

Efficiency and case drain flows

PV16, PV20, PV23

The efficiency and power graphs are measured at an input Speed of $n=1500\text{min}^{-1}$, a temperature of 50°C and a fluid Viscosity of $30\text{ mm}^2/\text{S}$.

Case drain flow and compensator control flow leave via the drain port of the pump. To the values shown are to be added 1 to 1.2 l/min, if at pilot operated compensators (code G*, H* horse power compensator and p/Q-control) the control flow of the pressure pilot valve also goes through the pump. Please note : The values shown below are only valid for Static operation. Under dynamic conditions and at rapid compensation of the pump the volume displaced by the servo piston also leaves the case drain port.

This dynamic control flow can reach up to 60 l/min!

Therefore the case drain line is to lead to the reservoir at full size and without restrictions as short and direct as possible.

Case drain flows

PV16-PV23

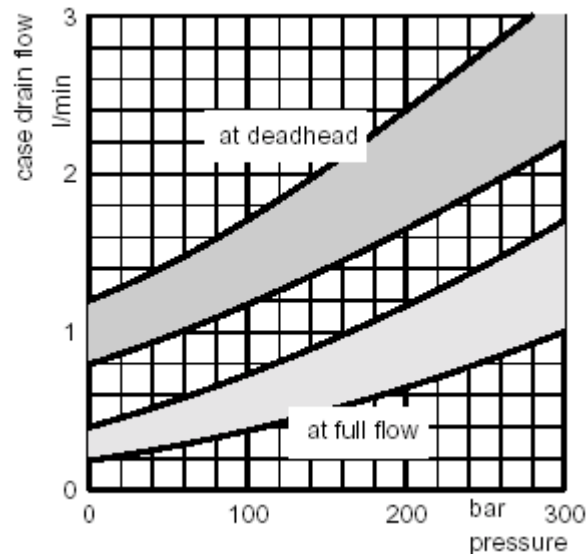

Dimensions

PV 16 - 23, metric version

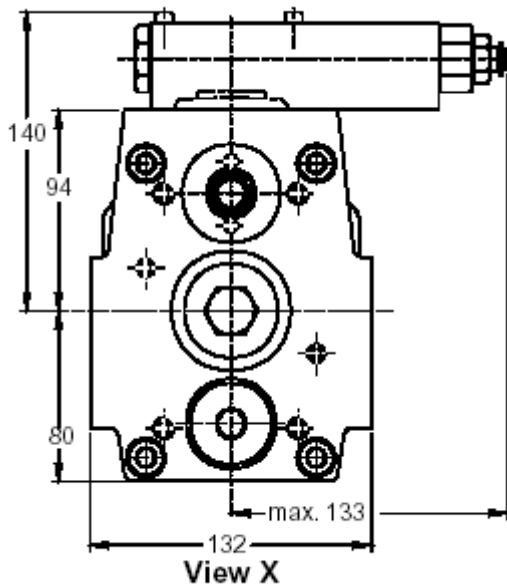

Shown with standard pressure compensator

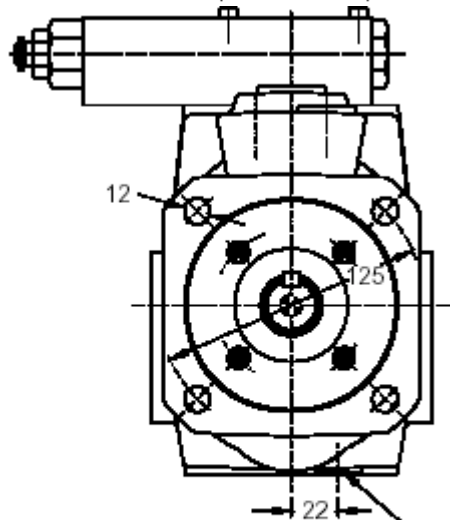

flushing port L3; G 3/8
optional M 18 x 1.5 (threads options 7)
oder 3/4 - 16 UNF (threads option 3)

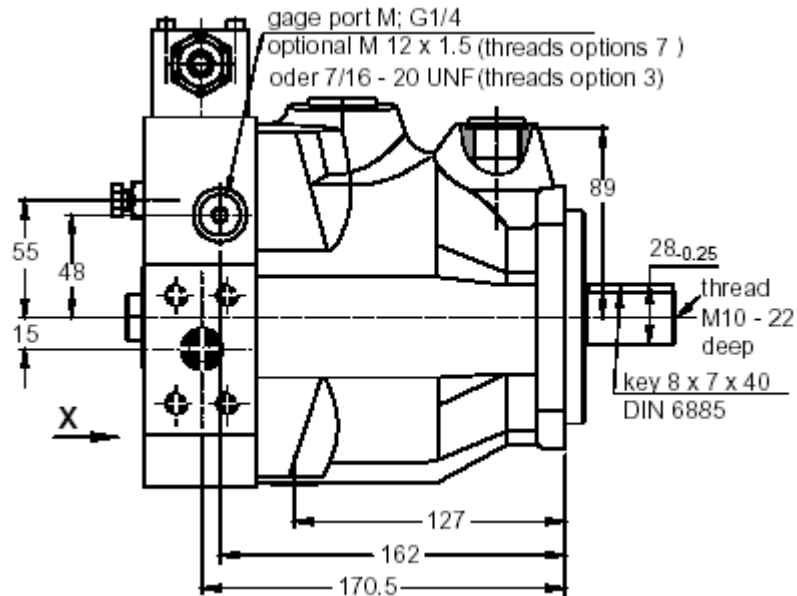
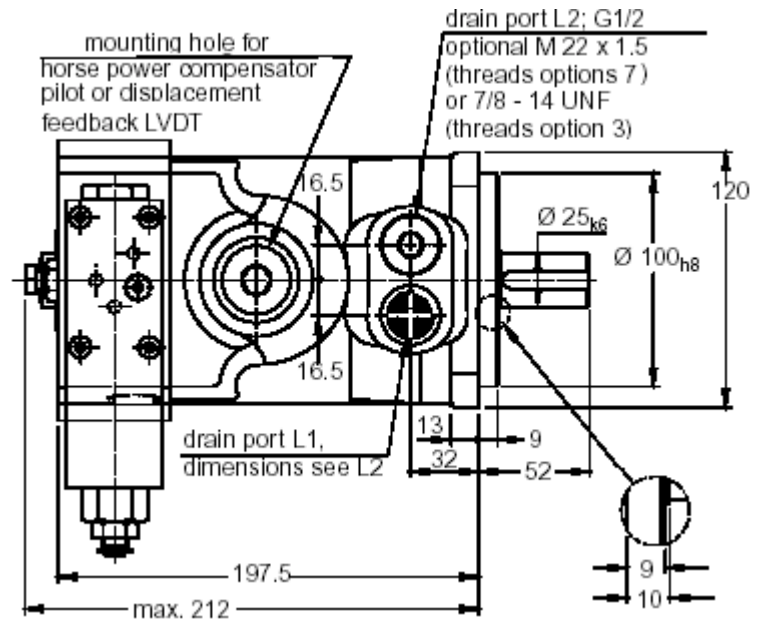

The pump shown above has mounting option **M+**
and thru drive option **B** (prepared for thru drive).

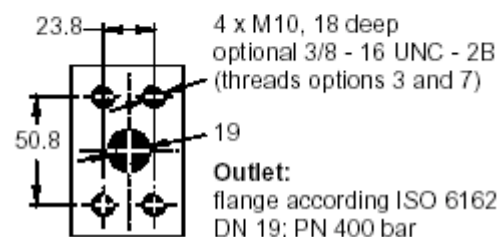
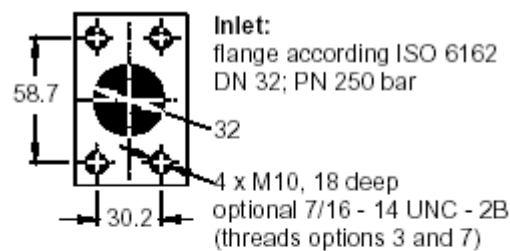
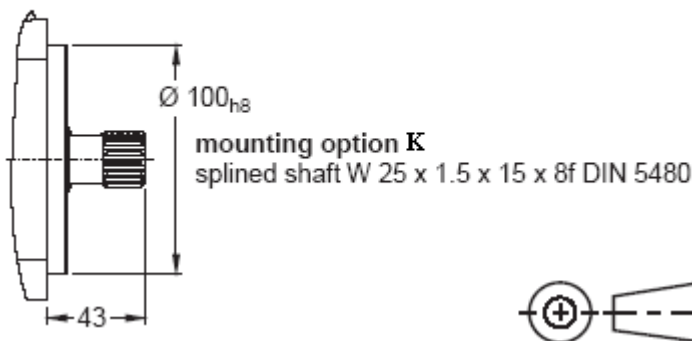

Dimensions

PV16 - 23, SAE version and thru drive

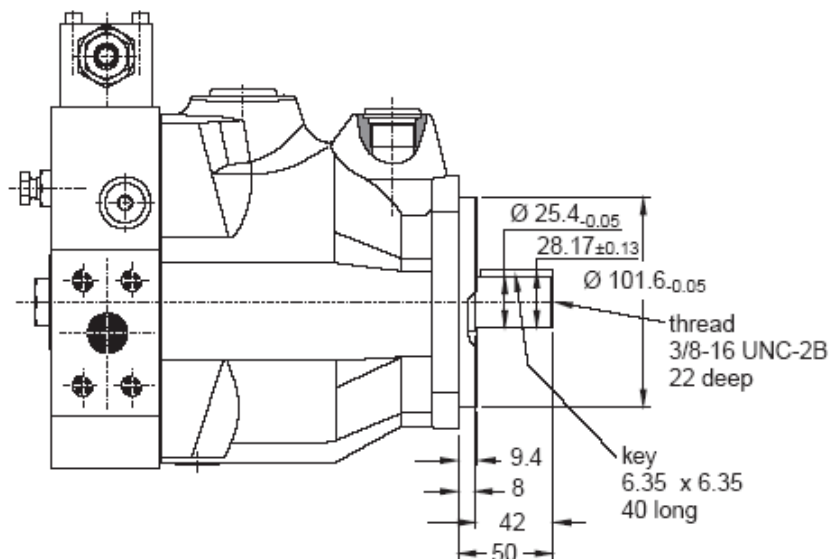
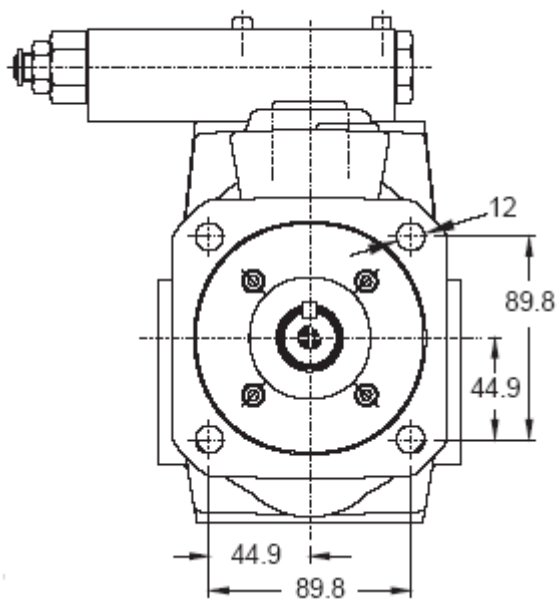

Shown above is mounting option M*

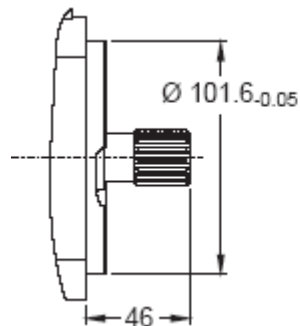

mounting option D

splined shaft 15T 16/32 DP, flat root, side fit
ANSI B92.1

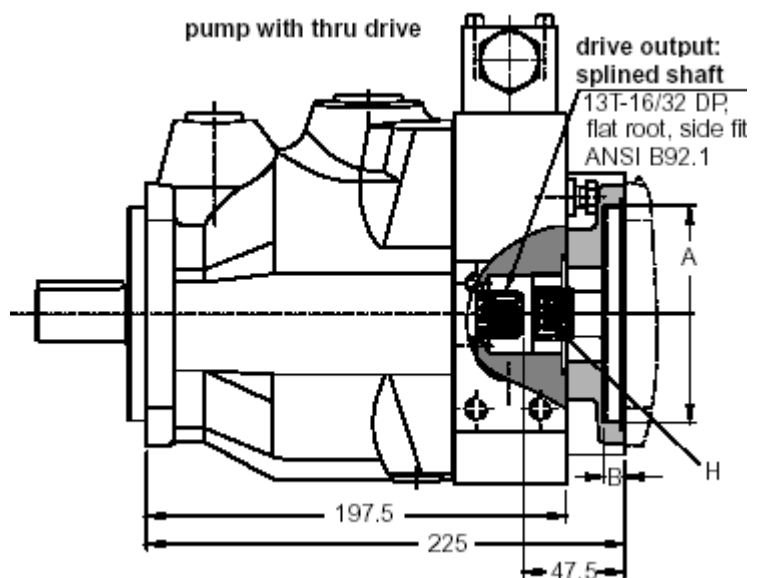
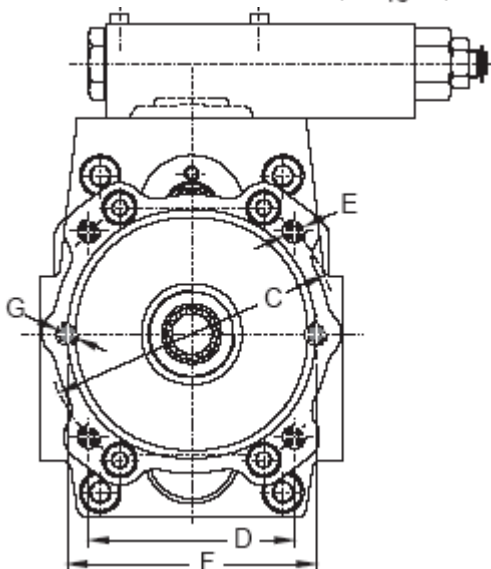

Thru shaft adaptors are available with the following dimensions:						
A	B	C	D	E	F	G
63	10	85	-	M8	100	M8
80	10	103	-	M8	109	M10
100	10.5	125	-	M10	n. avail.	n. avail.
50.8	10	-	-	-	82	M8
82.55	10	-	-	-	106	M10
101.6	10.5	-	89.8	M10	n. avail.	n. avail.

Dimension H and available couplings
At threads options 3 and 7
the dimensions E and G are
UNC - 2B threads.

